

THIS DRAWING IS UNPUBLISHED. RELEASED FOR PUBLICATION  
 © COPYRIGHT BY TYCO ELECTRONICS CORPORATION. ALL RIGHTS RESERVED.

LOC	DIST	REVISIONS					
GP	00	P	LTR	DESCRIPTION	DATE	DWN	APVD
			A	REV PER EC 0512-0573-04	05-04-05	JA	SF

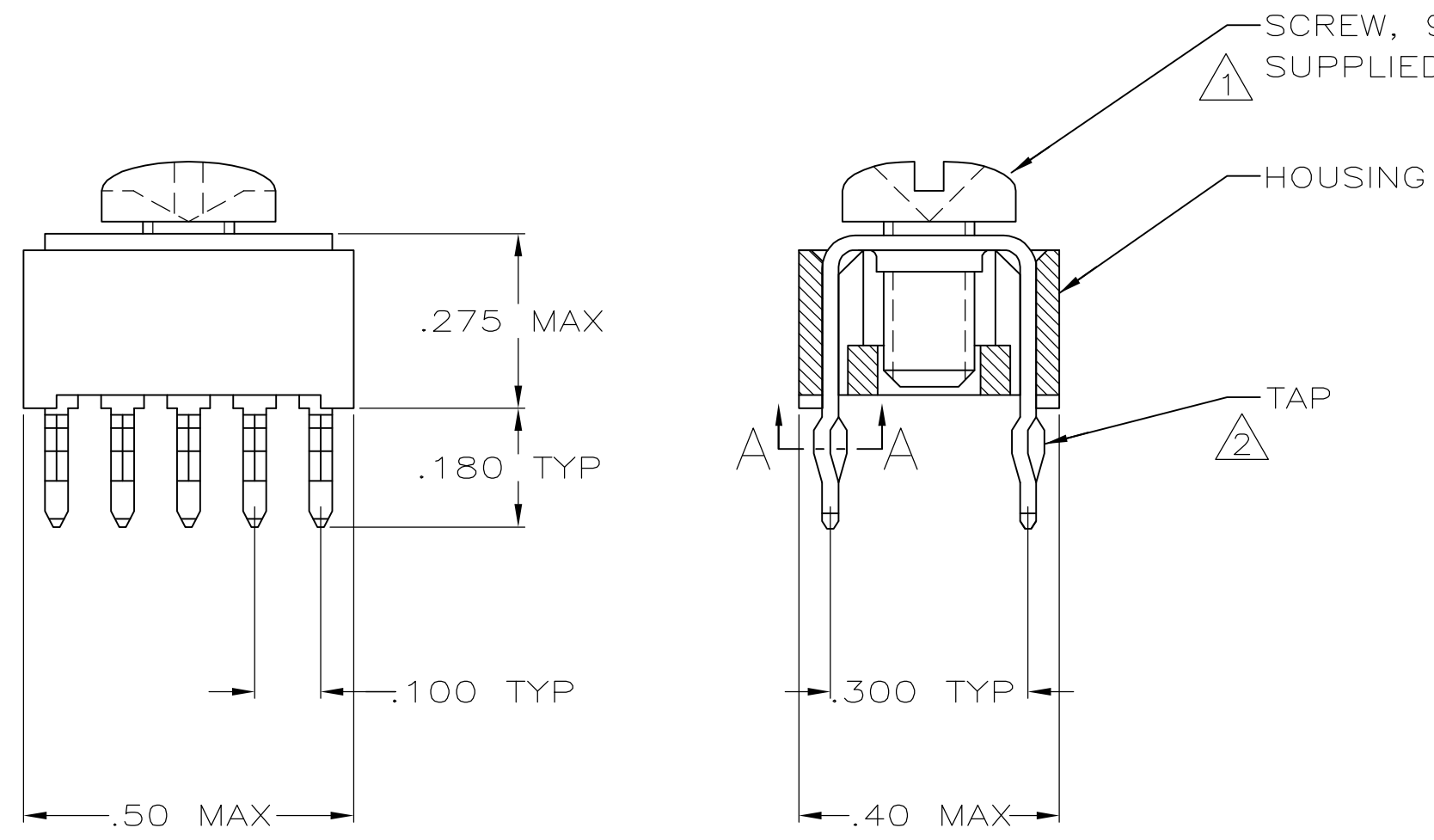

SCREW, 993879-1  
 SUPPLIED UNASSEMBLED, SEE TABLE

- ① TO PREVENT THREAD STRIPPING, SCREW TORQUE SHOULD NOT EXCEED 9 IN LBS.
- ② TAP HOLE IS 6-32UNC-2B, TWO MIN THREADS.
- ③ HOUSING: NYLON.
- ④ TAP: COPPER ALLOY 725, .025 THICK.
- ⑤ TAP: .000150 MATTE TIN OVER .000050 NICKEL.
- 6. REFERENCE APPLICATION SPECIFICATION 114-11000 FOR DRILL HOLE SIZES AND FINISHES.



SECTION A-A  
 SCALE 10:1  
 10 PLACES

YES	5055673-2
SCREW	PART NO.

THIS DRAWING IS A CONTROLLED DOCUMENT.		DWN	J. ALCORTA - DOCK5	05-04-05	<b>tyco</b> <b>Electronics</b>	Tyco Electronics Corporation Harrisburg, PA 17105-3608	
DIMENSIONS: INCHES		CHK	A. FRANTUM	05-04-05		NAME	
TOLERANCES UNLESS OTHERWISE SPECIFIED:		APVD	S. FLICKINGER	05-04-05	PRODUCT SPEC		
0 PLC ± -	1 PLC ± -	APPLICATION SPEC		108-11030			RESTRICTED TO
2 PLC ± -	3 PLC ± .010	WEIGHT		114-11000			
4 PLC ± -	ANGLES ± -	MATERIAL		SIZE			A3
FINISH		③ ④		CAGE CODE			
⑤		CUSTOMER DRAWING		DRAWING NO			C-5055673
		SCALE		SHEET			
		4:1		1 OF 1			REV
							A